



**22 Belgravia Court Abbey Foregate,  
Shrewsbury, SY2 6BW**  
£695 PCM



**monks**  
monks.co.uk



## Description

An attractive, well-appointed and much improved, modern, one bedroom apartment on the fringe of town centre apartment comprising: entrance hall, open-plan living area with adjoining refitted kitchen, one bedroom and refitted bathroom. Electric heating, double glazing. Attractive communal gardens, allocated parking space.

## IMPORTANT NOTICE

Information for tenants:

Rent: £695 per calendar month

Deposit: £801 Monks have considered that the deposit for this property is Equivalent to 5 weeks rent

Holding Deposit: £160 Equivalent to 1 Weeks Rent

Council Tax Band: A Please confirm the Council Tax band via Shropshire Council

Term: Assured Periodic Tenancy

Measurements: All measurements are approximate

Services: We are advised that mains water and electric are available

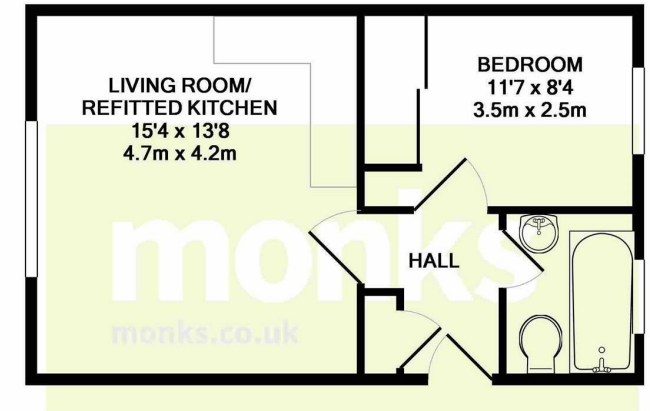
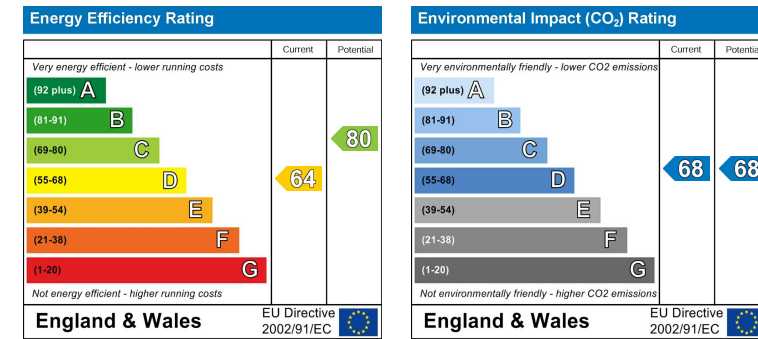

TOTAL APPROX. FLOOR AREA 389 SQ.FT. (36.1 SQ.M.)

Whilst every attempt has been made to ensure the accuracy of the floor plan contained here, measurements of doors, windows, rooms and any other items are approximate and no responsibility is taken for any error, omission, or mis-statement. This plan is for illustrative purposes only and should be used as such by any prospective purchaser. The services, systems and appliances shown have not been tested and no guarantee as to their operability or efficiency can be given  
Made with Metropix ©2017

**monks**  
monks.co.uk

10a-11 Shoplatch, Shrewsbury, Shropshire, SY1 1HL

info@monks.co.uk



Tel: 01743 361422

Fax: #

